



**2. Item No. AD1-2**

**Reference: DRAWING GOO1, GSK-01**

**Description:** Extend permeation grouting under the existing elevator pit to 4 feet below well hole. Protect existing elevator well hole, jack and piston. Maintain a minimum 2 foot clearance between well hole and permeation grouting. See GSK-01

**3. Item No. AD1-3**

**Reference: DRAWING GOO2, GSK-02**

**Description:** Extend permeation grouting under the existing elevator pit. Protect existing elevator well hole, jack and piston. See section GSK-02

**ATTACHMENTS:**

**Project Manual:**

**Site Phasing Plan 1 of 2**

**Drawings:**

AD1-ASK-01

1 Page, A001 Revised

AD1-GSK-01

1 Page, Elevator Pit and Mat Slab

AD1-GSK-02

1 Page, Soil Improvement at Elevator Mat Slab

**END OF ADDENDUM ITEMS**

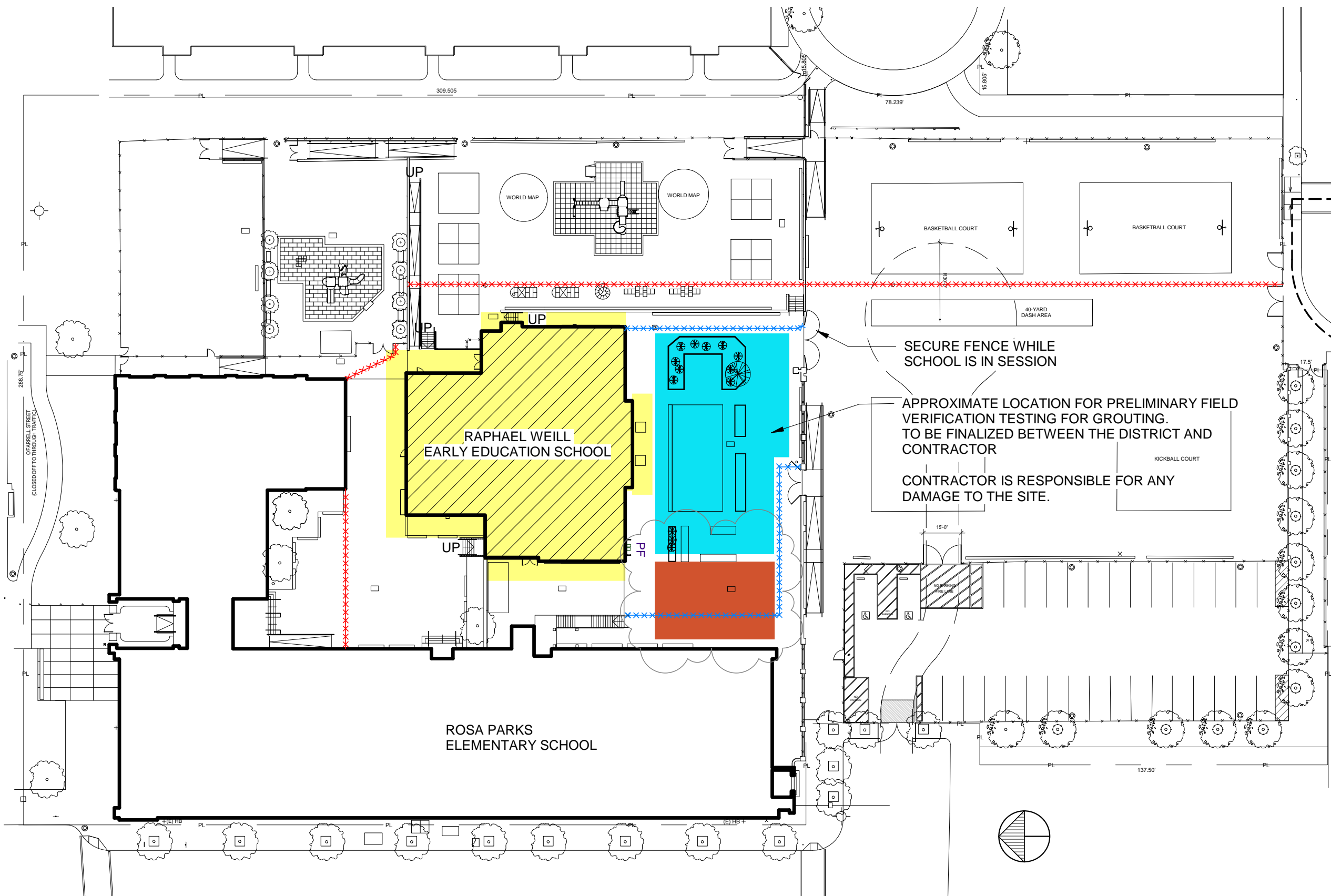

PHASE 1  
 APRIL 11, 2018 TO JUNE 13, 2018

PHASE 2  
 JUNE 14, 2018 TO JULY 20, 2018

PHASE 3  
 JUNE 14, 2018 TO AUGUST 3, 2018

 TEMP FENCING FOR PHASES 2 & 3

 TEMP FENCING FOR PHASE 1

**FINAL COMPLETION: SEPTEMBER 4, 2018.**  
 147 CALENDAR DAYS FROM NOTICE TO PROCEED. THIRTY (30 CALENDAR DAYS FROM THE END OF THE LAST PHASE).

 AREA NOT FOR CONTRACTOR USE

**RAPHAEL WEILL EARLY EDUCATION SCHOOL  
 STRUCTURAL STRENGTHENING - PHASING PLAN 1 OF 2**

# ATION SCHOOL ENING

## GENERAL NOTES, CONTINUED

### H. CONSTRUCTION

1. PENETRATIONS IN FIRE RATED ASSEMBLIES AND BEARING WALLS SHALL BE PROTECTED AS REQUIRED BY CBC CHAPTER 7.
  2. ALL NEW FINISH MATERIALS SHALL BE MAINTAINED IN A FLAME RETARDANT CONDITION. (CCR 1-19, SEC. 1, 14, 3.08, 3.21).
  3. ANY NEW FURRED CEILING SHALL BE CONSTRUCTED AS REQUIRED IN CBC SEC. 2504 AND TABLE 25A.
  4. ANY NEW SUSPENDED ACOUSTICAL CEILING BOARD SHALL BE NON-COMBUSTIBLE.
  5. NOT ALL CEILING APPURTENANCES (SMOKE DETECTORS, EXHAUST FANS, ACCESS DOORS, ETC.) ARE SHOWN. CONTRACTOR TO FIELD VERIFY AND TAKE APPROPRIATE ACTION TO ACCOMMODATE THESE ITEMS.
  6. ALL NEW WALL AND CEILING MATERIALS IN EXIT CORRIDORS SHALL COMPLY WITH CBC SEC. 1005.
  7. DEMOLITION OF BUILDINGS SHALL COMPLY WITH SECTION 8706 AND APPLICABLE PROVISIONS OF SECTIONS 8704 AND 8705.
- ### I. ROOFING AND INSULATION
1. WHERE CEILING OR ROOF MOUNTED EQUIPMENT/ PENETRATIONS ARE REQUIRED TO BE REMOVED OR INSTALLED/ RE-INSTALLED, PROVIDE ROOFING AND FLASHING TO ACCOMMODATE THE CONDITION.
  2. ALL INSULATION MATERIAL SHALL MEET THE CALIFORNIA QUALITY STANDARD PER SECTION 2.5311 B E S - 1986. ROOF INSULATION SHALL MEET CBC SECTION 1510 AND WALL INSULATION SHALL MEET CBC SECTION 1607.2.
  3. ALL ROOFING SHALL BE CLASS A FIRE RETARDANT.

## REGULATION REQUIREMENTS

### ADMINISTRATIVE REQUIREMENTS FROM PART 1 TITLE 24 C.C.R.

- ADDENDA MUST BE SIGNED BY ARCHITECT AND APPROVED BY DSA.
- NO CHANGES OR REVISIONS SHALL BE MADE FOLLOWING WRITTEN APPROVAL WHICH AFFECTS ACCESS COMPLIANCE ITEMS UNLESS SUCH CHANGES OR REVISIONS ARE SUBMITTED TO THE DSA FOR APPROVAL.
- SUBSTITUTIONS AFFECTING DSA REGULATED ITEMS SHALL BE SUBMITTED AS A CONSTRUCTION CHANGE DOCUMENT OR ADDENDA, AND SHALL BE APPROVED BY DSA PRIOR TO FABRICATION AND INSTALLATION.
- CONSTRUCTION CHANGE DOCUMENTS MUST BE SIGNED BY THE FOLLOWING:
  - ARCHITECT OR ENGINEER OF RECORD
  - STRUCTURAL ENGINEER (WHEN APPLICABLE)
  - DELEGATED PROFESSIONAL ENGINEER
  - DSA
- MATERIALS AND THEIR INSTALLATION SHALL COMPLY WITH APPLICABLE CODES, STANDARDS AND MANUFACTURER'S RECOMMENDATIONS.
- ALL DIMENSIONS ARE SUBJECT TO CONVENTIONAL INDUSTRY TOLERANCES EXCEPT WHERE THE REQUIREMENTS IS STATED AS A RANGE WITH SPECIFIC MINIMUM AND MAXIMUM END POINTS.
  - ADDENDA AND CHANGES AS PER SECTION 4-338
  - INSPECTOR APPROVED BY DSA AND EMPLOYED DIRECTLY BY DISTRICT.
  - INSPECTOR AND CONTINUOUS INSPECTION OF WORK PER SECTION 4-333(B) AND 4-342
  - TESTS AND TESTING LABORATORY PER SECTION 4-335 SHALL BE APPROVED BY DSA. (OWNER SHALL PAY THE TESTING LABORATORY)
  - SPECIAL INSPECTION PER SECTION 4-333 (C)
  - CONTRACTOR SHALL SUBMIT VERIFIED REPORT PER SECTION 4-336 & 4-343 (C)
  - ADMINISTRATION OF CONSTRUCTION PER PART 1, TITLE 24 C.C.R.
  - DUTIES OF ARCHITECT, STRUCTURAL ENGINEER, OR PROFESSIONAL ENGINEER PER SECTION 4-333 (A) AND 4-341
  - DUTIES OF CONTRACTOR PER SECTION 4-343
  - VERIFIED REPORTS PER SECTION 4-336
  - A COPY OF PART 16.2 OF TITLE 24, SHALL BE KEPT AND AVAILABLE IN THE FIELD DURING CONSTRUCTION
  - DSA SHALL BE NOTIFIED ON START OF CONSTRUCTION PER SECTION 4-331
  - SUPERVISION BY DSA PER SECTION 4-334

### SECTION 4-317 (C), PART 1, TITLE 24, C.C.R.

- 2016 CALIFORNIA BUILDING STANDARDS ADMINISTRATIVE CODE, PART 1, CBSC
- 2016 CALIFORNIA BUILDING CODE (CBC) PART 2, CBSC
- 2016 CALIFORNIA ELECTRICAL CODE (CEC) PART 3, CBSC
- 2016 CALIFORNIA MECHANICAL CODE (CMC) PART 4, CBSC
- 2016 CALIFORNIA PLUMBING CODE (CPC) PART 5, CBSC
- 2016 CALIFORNIA ENERGY CODE, PART 6, CBSC
- 2016 CALIFORNIA ELEVATOR SAFETY CONSTRUCTION CODE, PART 7, CBSC
- 2016 CALIFORNIA HISTORICAL BUILDING CODE, PART 8, CBSC
- 2016 CALIFORNIA FIRE CODE, PART 9, CBSC
- 2016 CALIFORNIA EXISTING BUILDING CODE, PART 10, CBSC
- 2016 CALIFORNIA GREEN BUILDING STANDARDS CODE, PART 12, CBSC
- 2016 CALIFORNIA REFERENCE STANDARDS CODE, PART 12, CBSC

### TITLE 8 C.C.R., CH. 4 SUB-CH. 6 - ELEVATOR SAFETY ORDERS

### TITLE 19, C.C.R., PUBLIC SAFETY, SFM REGULATIONS

### AMERICANS WITH DISABILITIES ACT (ADA), TITLE II OR TITLE III

### FOR TITLE II: UNIFORM FEDERAL ACCESSIBILITY STANDARDS (UFAS) 28 CFR 35.151(C) OR ADA STANDARDS FOR ACCESSIBLE DESIGN (APPENDIX A OF 28 CFR PART 36)

### FOR TITLE III: ADA STANDARDS FOR ACCESSIBLE DESIGN (APPENDIX A OF 28 CFR PART 36)

## SCOPE OF WORK

- ### STRUCTURAL/ SEISMIC UPGRADES:
- SOIL STABILIZATION & EXTERIOR WALL SHEAR WALL STRENGTHENING
  - REMOVAL OF SELECTED WINDOWS & INFILL OF OPENINGS
  - PATCHING OF FINISHES
  - REMOVAL & REPLACEMENT OF ELECTRICAL ITEMS IN PREPARATION FOR SHOTCRETE.

## HAZARDOUS MATERIALS

HAZARDOUS MATERIALS INCLUDING ASBESTOS-CONTAINING MATERIALS, LEAD-CONTAINING SURFACE COATINGS AND FLUORESCENT LAMPS HAVE BEEN IDENTIFIED. THESE MATERIALS WILL SIGNIFICANTLY IMPACT MODERNIZATION ACTIVITIES. SEE SECTION 0335 - EXISTING CONDITIONS. HAZARDOUS MATERIALS\* FOR LOCATIONS OF KNOWN OR ASSUMED HAZARDOUS MATERIALS.

## LOCAL MAP



## VINCINITY MAP

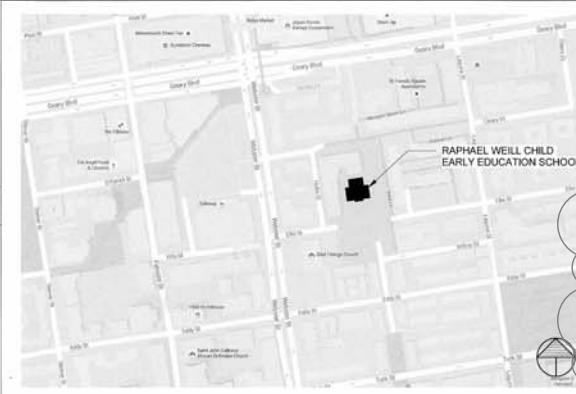

## PROJECT TEAM

RAPHAEL WEILL EARLY EDUCATION SCHOOL  
1501 O'FARRELL STREET  
SAN FRANCISCO CA 94115  
SAN FRANCISCO UNIFIED SCHOOL DISTRICT  
2011 PROP A BOND PROGRAM  
135 VAN NESS AVENUE  
SAN FRANCISCO, CA 94102  
TEL: 415 241-6152 X 3223

LEMANSKI & ROCKWELL ARCHITECTS INC  
1898 HYDE STREET  
SAN FRANCISCO, CA 94109  
TEL: 415 776-1220

TSA STRUCTURAL ENGINEERS  
433 AIRPORT BLVD, SUITE 106E  
BURLINGAME CA 94010  
TEL: 650 920-9555 FAX: 650 373 2040

ACG ELECTRICAL ENGINEERS  
6676 MISSION STREET #D  
DAILY CITY CA 94104  
TEL: 650-994-4800

ENGEQ INC  
101 CALIFORNIA STREET, SUITE 875  
SAN FRANCISCO CA 94111  
TEL: 415-284-9900

## DRAWING INDEX

A001	COVER SHEET & DRAWING INDEX
A002	GENERAL NOTES, GOVERNING CODES, BUILDING CODE ANALYSIS
A003	SITE - PATH OF TRAVEL & FIRE ACCESS PLAN
A004	SITE - PATH OF TRAVEL & FIRE ACCESS PLAN
A005	INTERIOR PATH OF TRAVEL & EXIT PLANS
A006	EXISTING ACCESSIBLE ENTRY RAMPS
A010	SITE DEMOLITION PLAN
A011	SITE PLAN
A101	DEMOLITION FLOOR PLANS
A201	FLOOR PLANS
A301	EXTERIOR ELEVATIONS NORTH & EAST
A302	EXTERIOR ELEVATIONS SOUTH & WEST
A401	ENLARGED RESTROOM PLANS
A501	INTERIOR ELEVATIONS
A601	REFLECTED CEILING PLAN
A901	DETAILS
G001	SOIL STABILIZATION DIAGRAMS
G002	SOIL STABILIZATION DETAILS
S01	GENERAL NOTES
S1	NOTES & DETAILS
S2	LOWER & UPPER LEVEL FOUNDATION PLANS
S3	EXTERIOR ELEVATIONS
S4	EXTERIOR ELEVATIONS
S5	SECTIONS
S6	SECTIONS
E001	GENERAL NOTES, DEMOLITION NOTES, AND SPECIFICATIONS
E301	EXTERIOR ELEVATIONS NORTH & SOUTH
E302	EXTERIOR ELEVATIONS SOUTH & WEST

### FOR REFERENCE ONLY

TOPOGRAPHIC SURVEY DATED 01-17-2018 PREPARED BY PACIFIC ENGINEERING & CONSTRUCTION INC.  
TOPOGRAPHIC SURVEY DATED 10-30-2007 - SHEETS 1 THROUGH 4, PREPARED BY LEA & BRAZE ENGINEERS  
CIVIL SHEET C1 - UTILITY RELOCATION PLAN DATED 03-27-2008, PREPARED BY ILS ASSOCIATES, INC.

DEFERRED SUBMITTALS: SOIL IMPROVEMENT - CAS FINAL ACCEPTANCE OF SHOTCRETE REPAIR



SFUSD SAN FRANCISCO PUBLIC SCHOOLS

## 2011 PROPOSITION A BOND PROGRAM

135 Van Ness Avenue  
San Francisco, California 94102  
Tel (415) 241-6152  
Fax (415) 241-6148



## LEMANSKI & ROCKWELL architects

1898 Hyde St. SF CA 94109 | 415.776.1220  
lemanskicrockwell.com

1

## RAPHAEL WEILL EES STRUCTURAL STRENGTHENING

1501 O'FARRELL STREET  
SAN FRANCISCO, CA 94115

Date	No.	Revisions
10/30/17	1	DSA SUBMITTAL
02/13/18	1	BID
03/01/18	1	ADDENDUM 1

FILE NUMBER: 38-1



## COVER SHEET & DRAWING INDEX

SHEET NO.	JOB NO.
<b>A001</b>	15002
PRINTED: 1/17/2018 4:24:48 PM	DRAFTER: NI
CHECKED BY: JAL	SITE NO.:
SCALE: As indicated	S.F.U.S.D. PROJECT NO. 11054

LEMANSKI & ROCKWELL architects

SHEET A001 - R1

ASK-01

SFUSD PROJECT NUMBER 11512 | SCALE: | DSA NO.: 01-116986 FILE: 38-1 | DATE: 02/27/18 18:29:30

1898 Hyde Street, San Francisco CA 415.776.1220

SAN FRANCISCO UNIFIED SCHOOL DISTRICT  
RAPHAEL WEILL EARLY EDUCATION SCHOOL - STRUCTURAL STRENGTHENING  
1501 O'FARRELL STREET, SAN FRANCISCO CA 94115

REF:  
REVISION:

3.1 4 5 6

EDGE OF (E) MAT SLAB AND  
EXTENT OF SOIL IMPROVEMENT:  
4'-0" PERMEATION GROUTING  
OVER COMPACTION GROUTING

(E) GUIDE RAIL  
(E) SPRING  
BUFFER  
(E) SUMP

J.1

J

1  
GSK-02

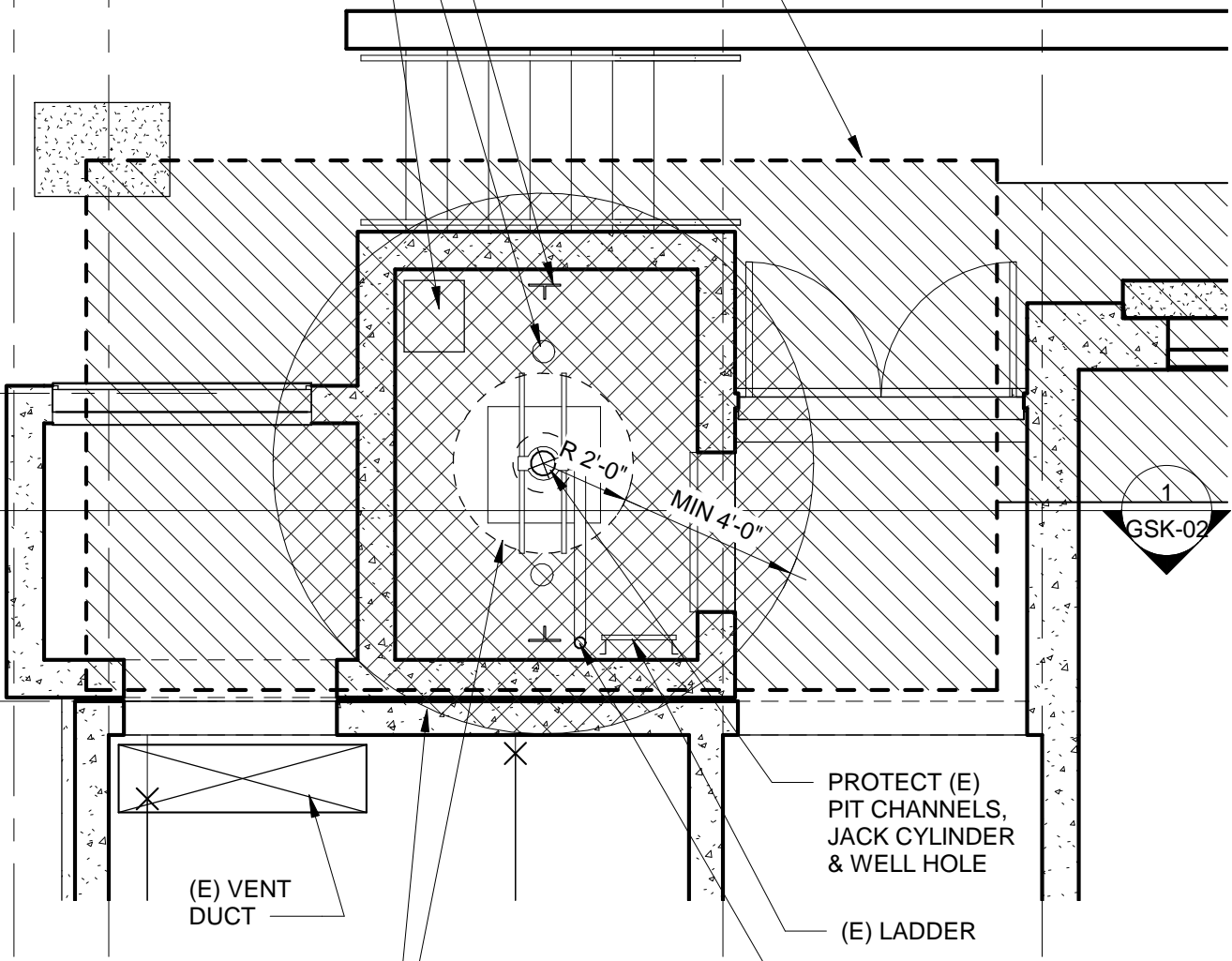

ZONE OF EXTENDED  
PERMEATION GROUTING -  
EXTEND PERMEATION GROUTING  
TO 18'-0" BELOW PIT FLOOR AND  
MAINTAIN A MIN. 2'-0" CLEARANCE  
FROM CYLINDER JACK.

PROTECT (E)  
PIT CHANNELS,  
JACK CYLINDER  
& WELL HOLE  
  
(E) LADDER  
  
HYDRAULIC  
SUPPLY PIPE

1 ELEVATOR PIT PLAN  
1/4" = 1'-0"

	<b>ELEVATOR PIT AND MAT SLAB</b>			<b>GSK-01</b>
	SFUSD PROJECT NUMBER 11512	SCALE: 1/4" = 1'-0"	DSA NO.: 01-116986 FILE: 38-1	DATE: 2/28/2018 2:02:10 PM
	SAN FRANCISCO UNIFIED SCHOOL DISTRICT RAPHAEL WEILL EARLY EDUCATION SCHOOL - STRUCTURAL STRENGTHENING 1501 O'FARRELL STREET, SAN FRANCISCO CA 94115			REF:
				REVISION:

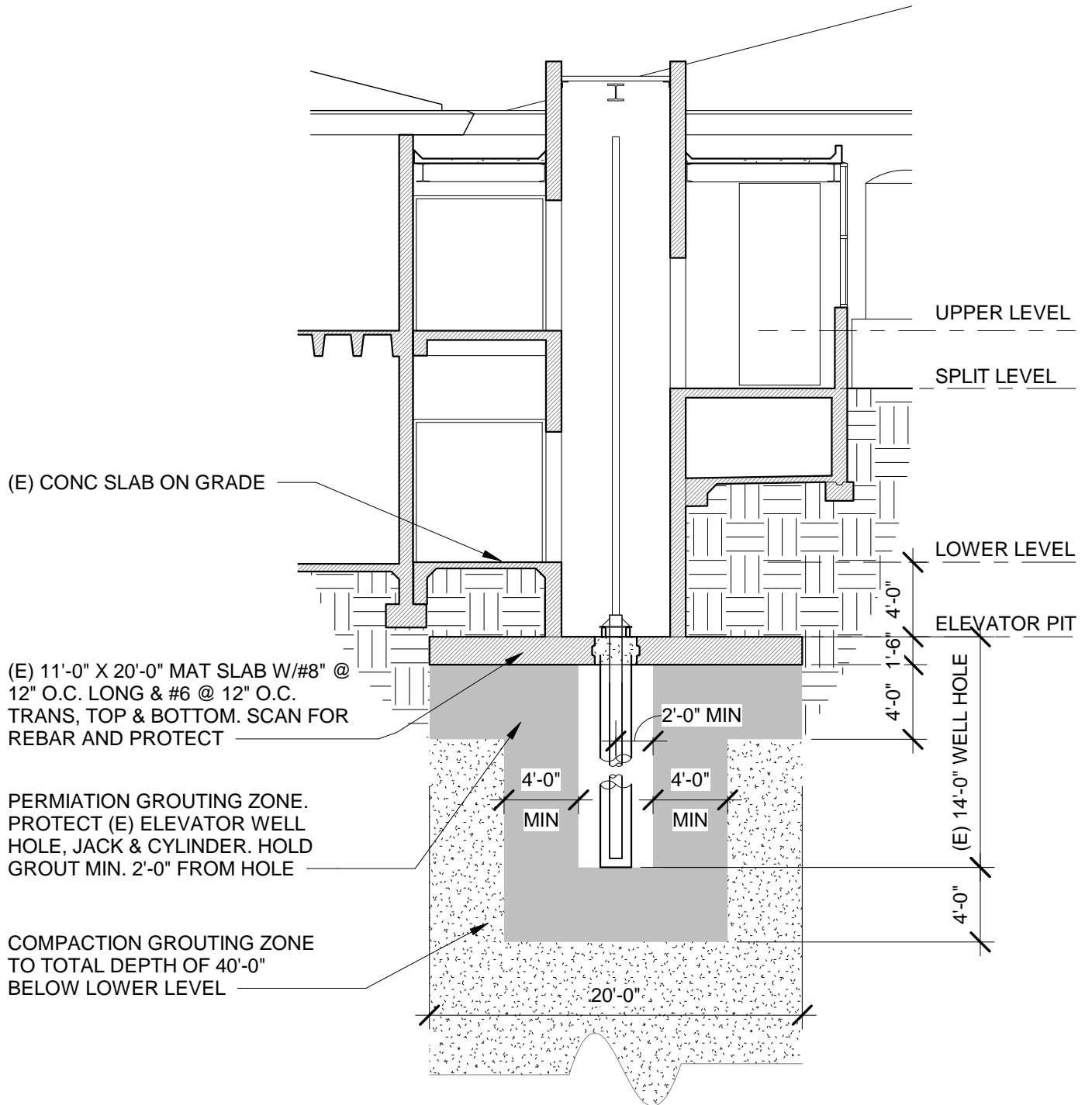

1 Elevator Mat Slab & Well Hole - Soil Improvement  
 1/8" = 1'-0"



**SOIL IMPROVEMENT AT ELEVATOR MAT SLAB**

**GSK-02**

SFUSD PROJECT NUMBER 11512	SCALE: 1/8" = 1'-0"	DSA NO.: 01-116986 FILE: 38-1	DATE: 2/28/2018 2:02:11 PM
SAN FRANCISCO UNIFIED SCHOOL DISTRICT RAPHAEL WEILL EARLY EDUCATION SCHOOL - STRUCTURAL STRENGTHENING 1501 O'FARRELL STREET, SAN FRANCISCO CA 94115			REF:
			REVISION: