



Leonard Flynn CDC

3125 Cesar Chavez Street
 San Francisco, CA 94110
[Map](#) [Public transit](#)
 Tel: (415)695-5782
 Fax: (415)695-5440

ALTERNATE
 FORMAT:

中文

Español

Large Print

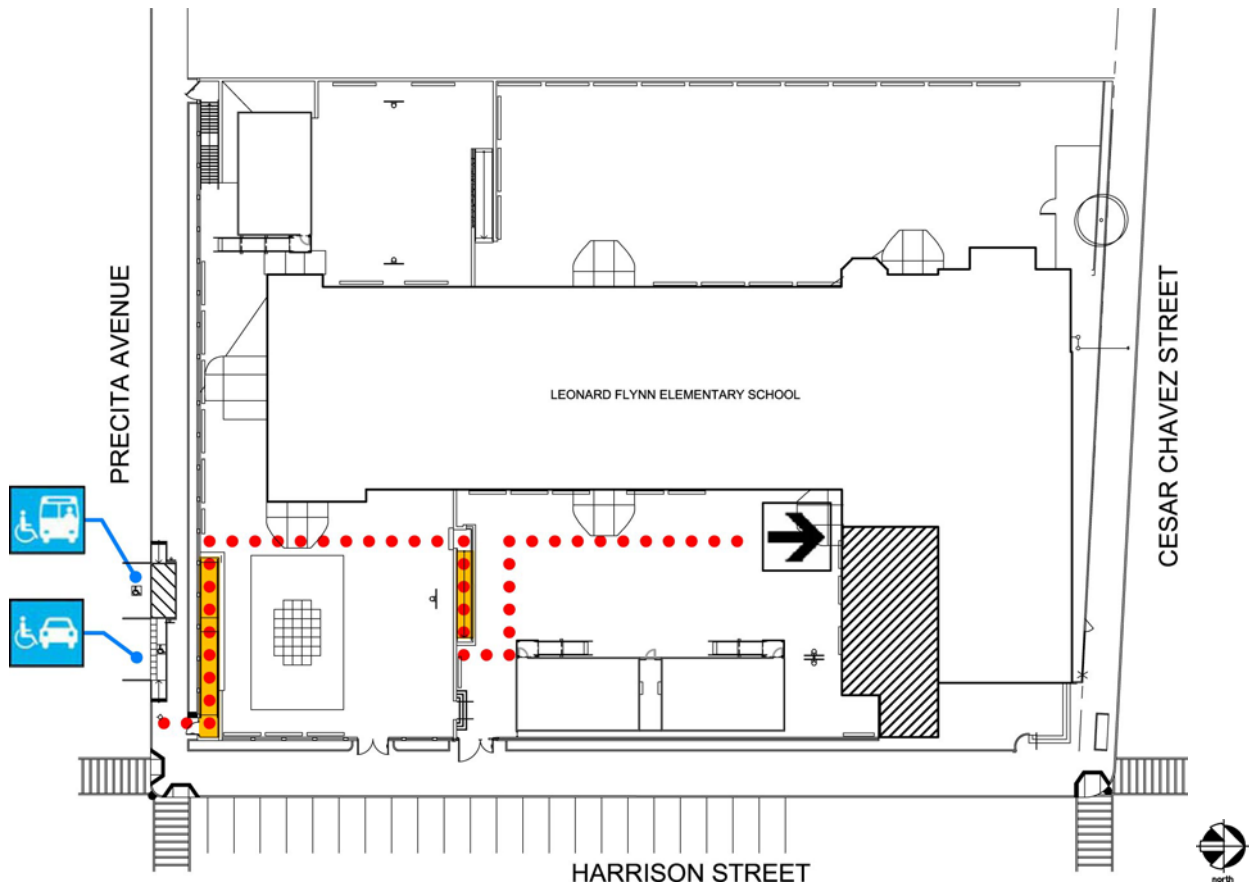

Site Plan

Accessibility		Location
.....	Access path of travel	From Precita Avenue, down ramps in towards play yards and front entrance.
	Accessible parking space	on Precita Avenue
	Accessible passenger loading zone	on Precita Avenue
	Accessible entrance	On south west corner of building from the lower east play yard.
	Ramp	Ramps for playground access.



Leonard Flynn CDC

3125 Cesar Chavez Street
 San Francisco, CA 94110

[Map](#) [Public transit](#)

Tel: (415)695-5782

Fax: (415)695-5440

ALTERNATE
 FORMAT:



中文

Español

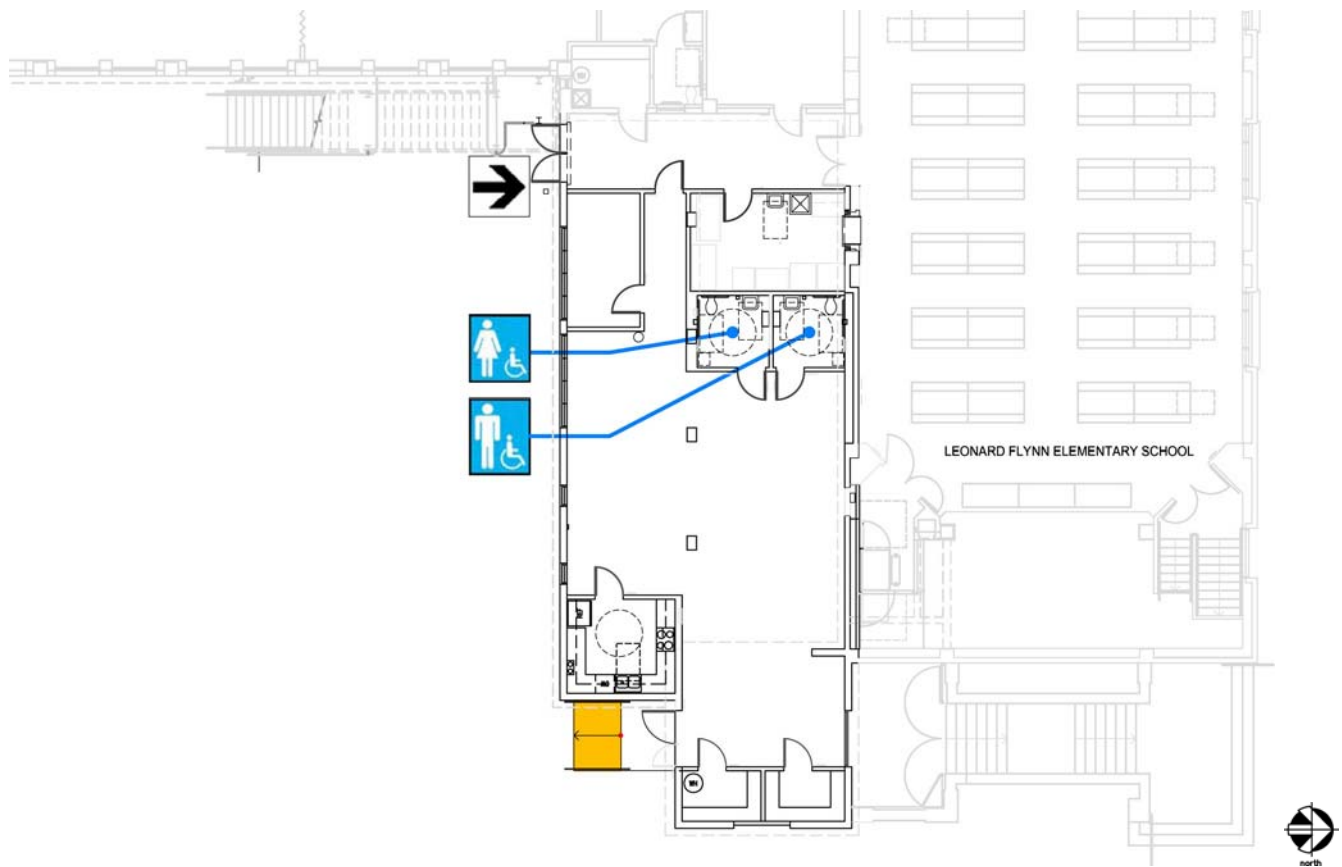
Large Print



First Floor Plan

Accessibility		Location
	Accessible entrance	On south west corner of building.
	Ramp	Ramp on south east corner of building.
	Boys' & Girls restroom	Restrooms located on northwest side of room.



Leonard Flynn CDC

3125 Cesar Chavez Street
San Francisco, CA 94110
[Map](#) [Public transit](#)
Tel: (415)695-5782
Fax: (415)695-5440

ALTERNATE
FORMAT:



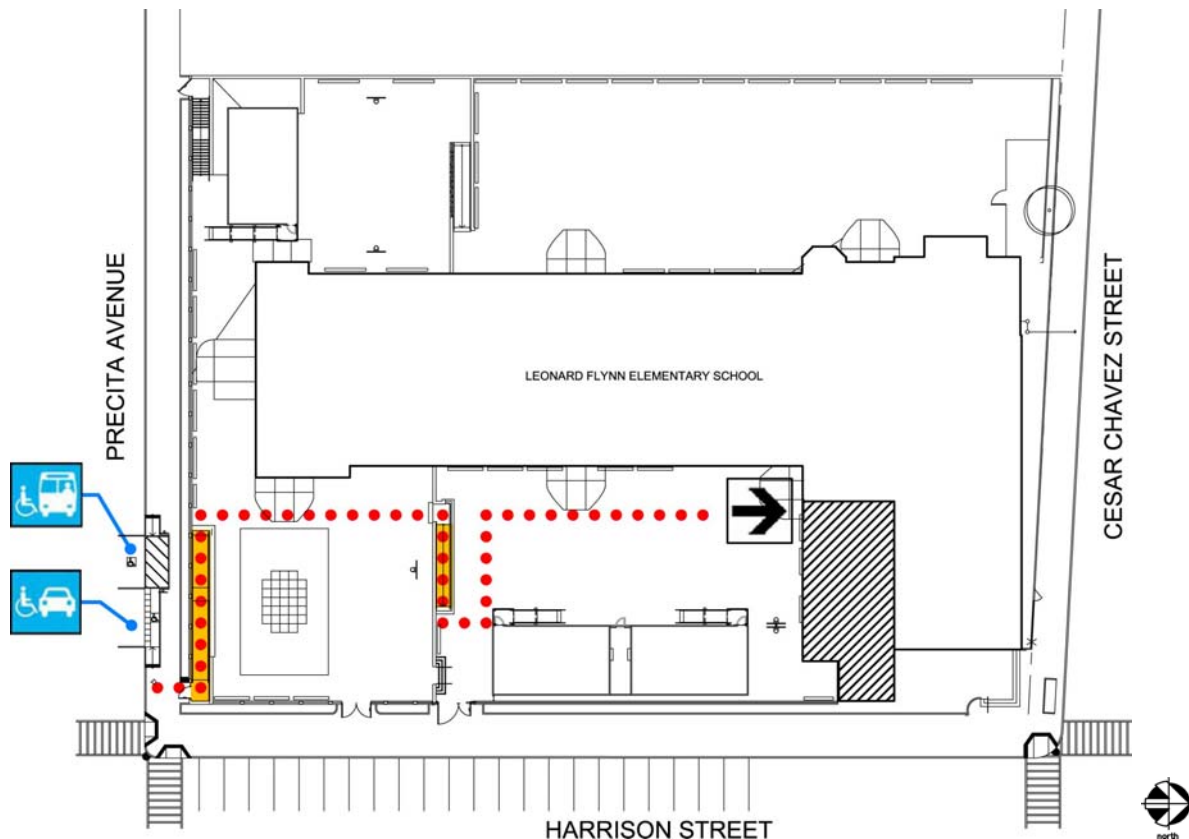

中文

Español

Large Print



校舍平面圖

殘障人士專用設施		位置
.....	專用通道	沿 Precita 街(Precita Avenue), 輪椅坡道徒下行, 進入操場和正門。
	專用車位	位於 Precita 街。
	殘障人士上落專區	位於 Precita 街。
	專用入口	位於校舍西南面, 可從操場(東面)直達。
	輪椅坡道	多條輪椅坡道可通往操場。



Leonard Flynn CDC

3125 Cesar Chavez Street
San Francisco, CA 94110

[Map](#) [Public transit](#)

Tel: (415)695-5782

Fax: (415)695-5440

ALTERNATE
FORMAT:



中文

Español

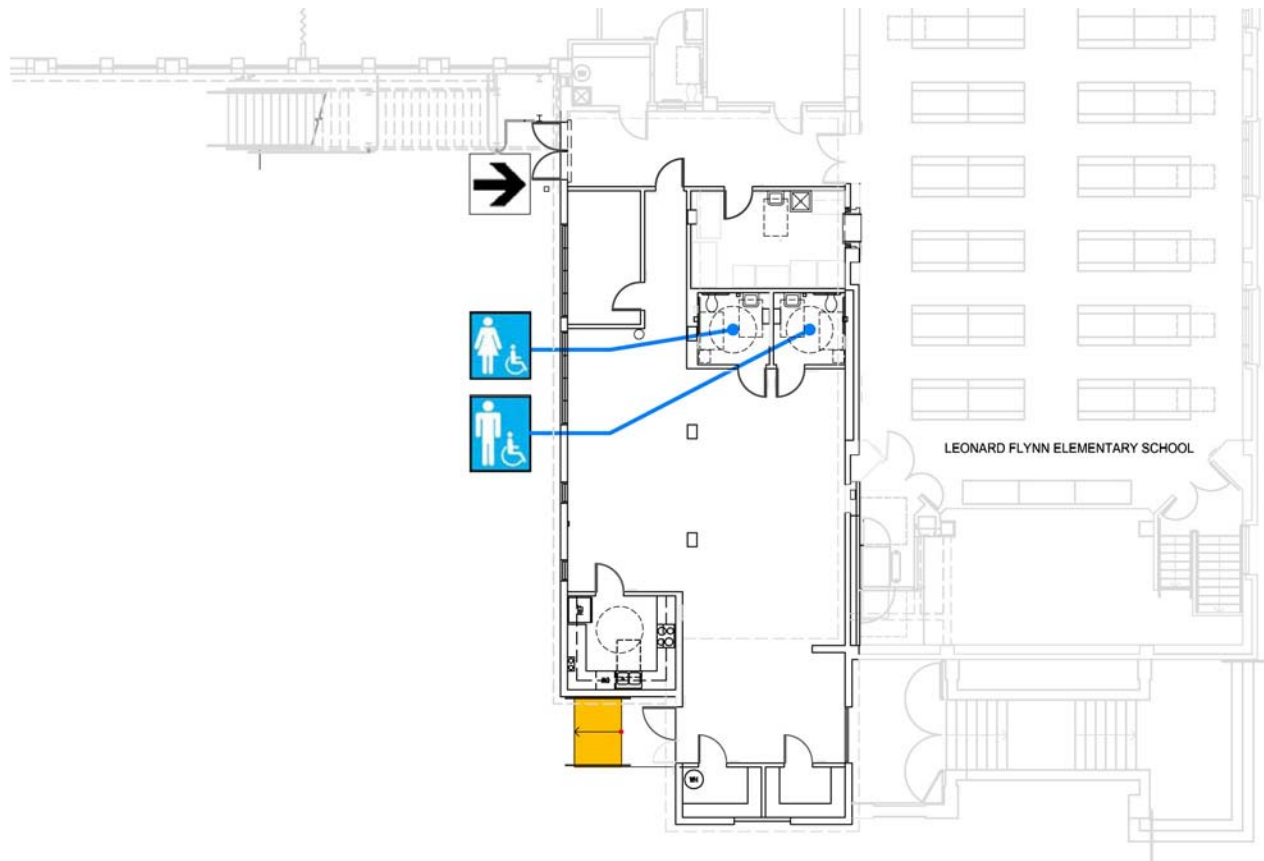
Large Print



一樓平面圖

殘障人士專用設施		位置
	專用入口	位於校舍西南面。
	輪椅坡道	輪椅坡道設於校舍東南面。
	男女生洗手間	洗手間設於課室西北面。



Leonard Flynn CDC

3125 Cesar Chavez Street
San Francisco, CA 94110
[Mapa](#) [Transporte Público](#)
Tel: (415)695-5782
Fax: (415)695-5440

ALTERNATE
FORMAT:



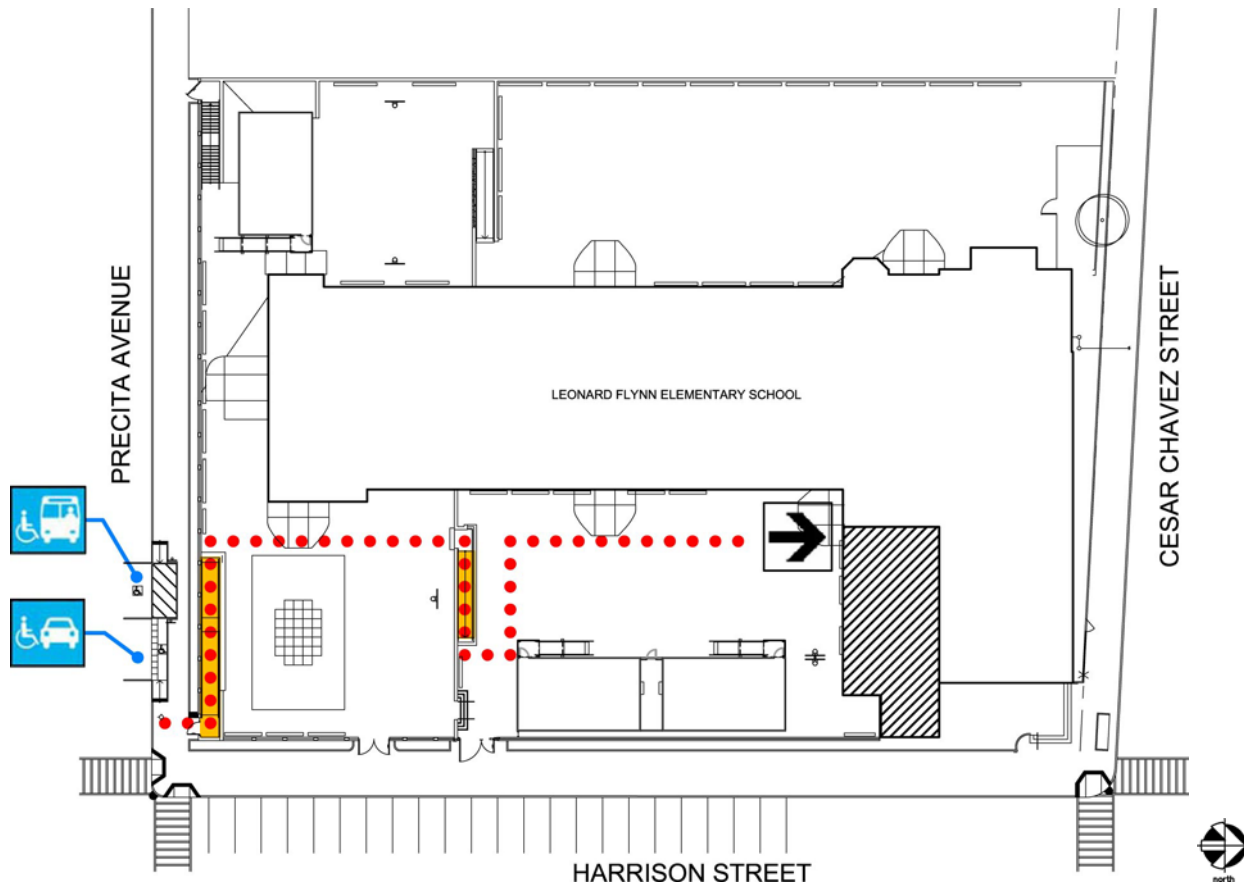

中文

Español

Large Print



Plano de la escuela

Accesibilidad		Ubicación
.....	Acceso peatonal	De la avenida Precita, a las rampas inferiores con dirección al patio de recreo y la entrada frontal
	Espacio de acceso para estacionamiento	En la avenida Precita
	Zona de acceso para pasajeros	En la avenida Precita
	Entrada de acceso	En la esquina oeste de las instalaciones desde la parte este inferior del patio de recreo
	Rampa	Las rampas de acceso al patio de recreo



Leonard Flynn CDC

3125 Cesar Chavez Street
 San Francisco, CA 94110
[Mapa](#) [Transporte Público](#)
 Tel: (415)695-5782
 Fax: (415)695-5440

ALTERNATE
 FORMAT:



中文

Español

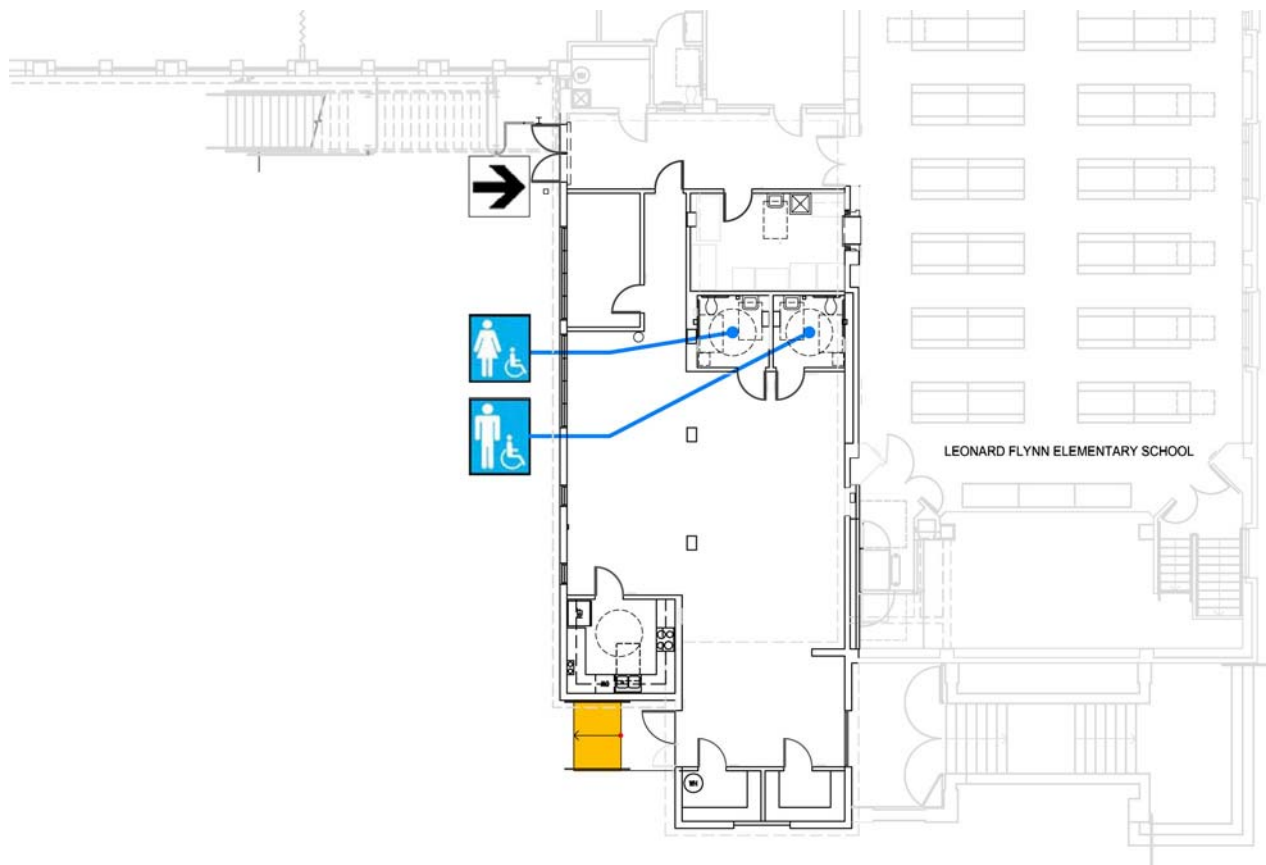
Large Print



Plano del primer piso

Accesibilidad		Ubicación
	Acceso de entrada	En la esquina suroeste de las instalaciones
	Rampa	Rampa en la esquina sureste de las instalaciones
	Baños de hombres, mujeres y de uso común.	Que se ubican al lado noroeste del salón