

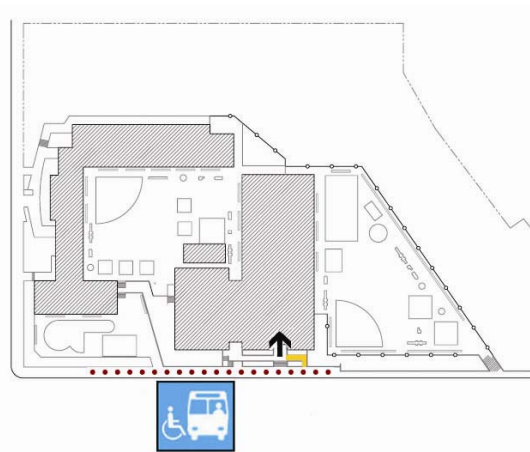









## El Dorado Elementary School

70 Delta Street  
San Francisco, CA 94134  
Tel: (415) 330-1537  
Fax: (415) 330-1583



## Site Plan

● Accessible ◆ Functionally accessible

| Accessibility   |  | Location  | Condition |
|---|--|---|-----------|
|  | Access path of travel                        | From Delta Street, east side of school                            | ●         |
|  | Accessible parking stall                     | None  |           |
|  | Passenger loading zone                       | On Delta Street in front of school                                | ●         |
|  | Accessible entrance                          | From Delta Street via ramp, east side of school                   | ●         |
|  | Ramp   | At Delta Street in front of school leading to accessible entrance | ●         |
|  | Boys' toilet, Girls' toilet, Unisex restroom | See other plans for locations                                     |           |
|  | Drinking fountain                            | See other plans for locations                                     |           |
|  | Elevator                                     | None  |           |
|  | TTY (text telephone)                         | None  |           |

### School Access Description

**Drinking fountains:** ● Drinking fountains located in middle and upper yards are not ADA compliant

## El Dorado Elementary School

70 Delta Street  
San Francisco, CA 94134  
Tel: (415) 330-1537  
Fax: (415) 330-1583

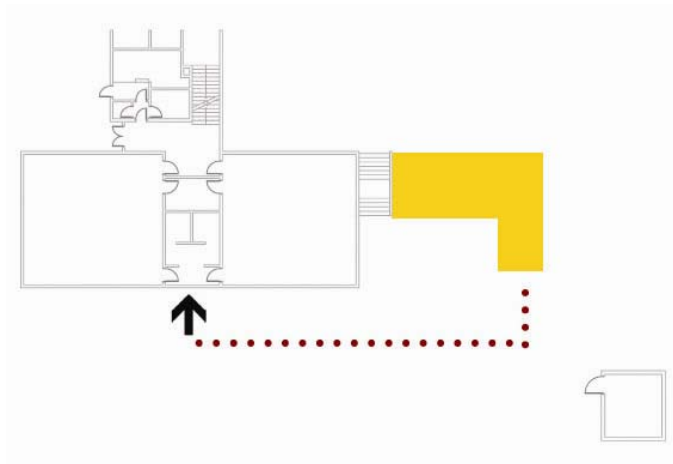

## Basement Floor Plan

• Accessible ♦ Functionally accessible

| Accessibility                                | Location   | Condition |
|--|--|-----------|
| Access path of travel                        | Not applicable   |           |
| Accessible parking stall                     | Not applicable   |           |
| Passenger loading zone                       | Not applicable   |           |
| Accessible entrance                          | Through middle yard to lower yard kindergarten classrooms via ramp | •         |
| Ramp   | At middle yard   |           |
| Boys' toilet, Girls' toilet, Unisex restroom | None on this floor   |           |
| Drinking fountain                            | None on this floor   |           |
| Elevator                                     | None   |           |
| TTY (text telephone)                         | None   |           |

### School Access Description

- Restrooms:**
- Student restrooms located between two kindergarten classrooms are not ADA compliant.
- Drinking fountains:**
- Drinking fountains located in classrooms are not ADA compliant.
- Elevator:**
- No elevator access in school.





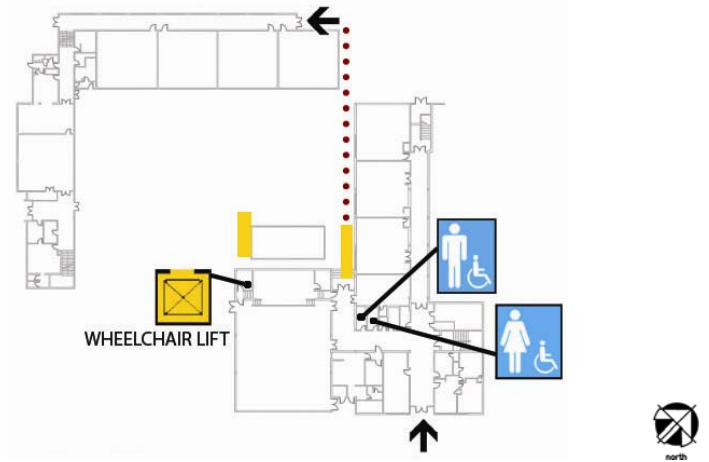



## El Dorado Elementary School

70 Delta Street  
San Francisco, CA 94134  
Tel: (415) 330-1537  
Fax: (415) 330-1583



## First Floor Plan

• Accessible ♦ Functionally accessible

| Accessibility  | Location  | Condition |
|--|---|-----------|
|  Access path of travel                        | Along corridors to middle yard via ramp           | •         |
|  Accessible parking stall                     | Not applicable                                    |           |
|  Passenger loading zone                       | Not applicable                                    |           |
|  Accessible entrance                          | From Delta Street, east side of school            |           |
|  Ramp   | In middle yard and at portable classroom entrance | •         |
|  Boys' toilet, Girls' toilet, Unisex restroom | Student and women restrooms at corridor           | •         |
|  Drinking fountain                            | None on this floor                                |           |
|  Elevator                                     | None  |           |
|  TTY (text telephone)                         | None  |           |

### School Access Description

- Restrooms:**
- Unisex staff restroom located in office area is not ADA compliant.
- Drinking fountains:**
- Drinking fountain located in front of restrooms at corridor is not ADA compliant.
- Accessibility:**
- Platform lift provides access to Multi-Purpose Room stage.
  - Platform lift provides access in classroom wing/Library.
- Elevator:**
- No elevator access in school.





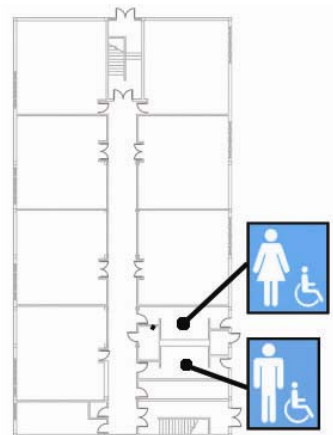



## El Dorado Elementary School

70 Delta Street  
 San Francisco, CA 94134  
 Tel: (415) 330-1537  
 Fax: (415) 330-1583



## Second Floor Plan

• Accessible ♦ Functionally accessible

| Accessibility   |  | Location   | Condition |
|---|--|--|-----------|
|  | Access path of travel                        | Not applicable                                     | •         |
|  | Accessible parking stall                     | Not applicable                                     |           |
|  | Passenger loading zone                       | Not applicable                                     |           |
|  | Accessible entrance                          | Not applicable                                     |           |
|  | Ramp   | Not applicable                                     |           |
|  | Boys' toilet, Girls' toilet, Unisex restroom | Student restrooms at north side of center corridor | •         |
|  | Drinking fountain                            | None on this floor                                 |           |
|  | Elevator                                     | None   |           |
|  | TTY (text telephone)                         | None   |           |

### School Access Description

- Restrooms:**
- Unisex staff restroom located at end of center corridor is not ADA compliant.
- Elevator:**
- No elevator access in school. This floor is not accessible.