

Guadalupe Elementary School

859 Prague Street
 San Francisco, CA 94112
 Tel: (415) 469-4718
 Fax: (415) 469-4066

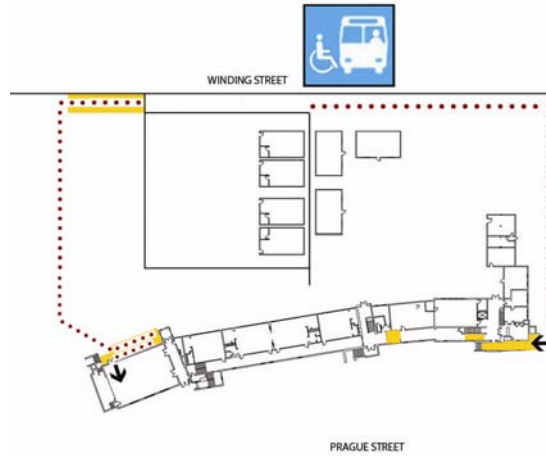

Site Plan

• Accessible ♦ Functionally accessible

Accessibility	Location	Condition
Access path of travel	From Winding Street travel west around the street corner to Cordova Street and travel east to Prague Street	•
Accessible parking stall	None	
Passenger loading zone	On Winding Street, south side of school	•
Accessible entrance	On Prague Street, north side of school	•
Ramp	At main entrance along Prague Street At entrance to portable classrooms	•
Boys' toilet, Girls' toilet, Unisex restroom	See other plans for locations	
Drinking fountain	See other plans for locations	
Elevator	See other plans for locations	
TTY (text telephone)	None	

School Access Description

Accessibility:

- Access to upper yard is from Winding Street through gate and from building lobby.
- The upper and middle yards are connected via stairs.
- The middle and lower yards are connected by gate.
- Access to lower yard is from Winding Street through gate via ramp.
- Portable classrooms are accessible via ramps.

Guadalupe Elementary School

859 Prague Street
San Francisco, CA 94112
Tel: (415) 469-4718
Fax: (415) 469-4066

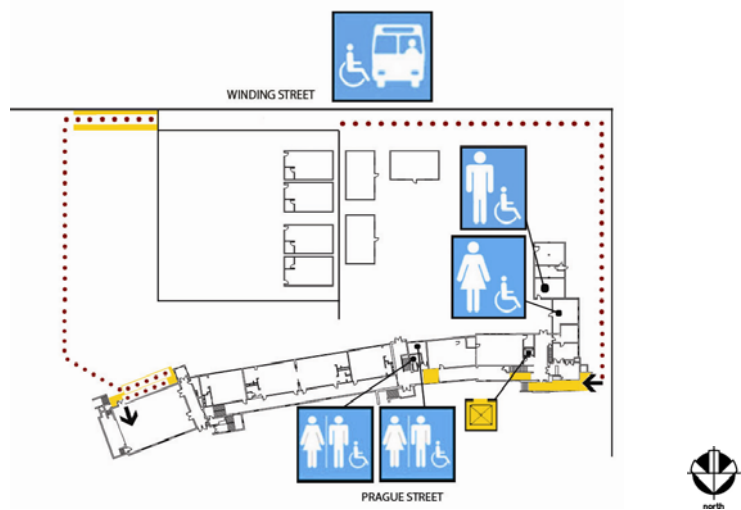

First Floor Plan

• Accessible ♦ Functionally accessible

Accessibility		Location	Condition
	Access path of travel	From lobby along corridors	•
	Accessible parking stall	Not applicable	
	Passenger loading zone	Not applicable	
	Accessible entrance	From Prague Street via ramp, north side of school	•
	Ramp	At corridors	•
	Boys' toilet, Girls' toilet, Unisex restroom	Student restrooms at yard Staff restrooms at center corridor	•
	Drinking fountain	None on this floor	
	Elevator	At corridor serves 1st and 2nd floor	•
	TTY (text telephone)	None	

School Access Description

Accessibility:

- Access to Multi-Purpose Room is from lower yard via ramp.

Drinking fountains:

- Multi-Purpose Room stage is not accessible.
- Drinking fountains located at corridors are not ADA compliant.





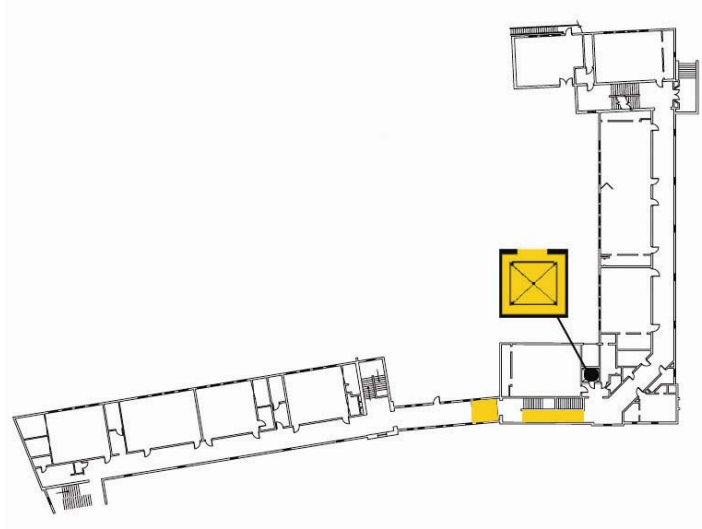



Guadalupe Elementary School

859 Prague Street
San Francisco, CA 94112
Tel: (415) 469-4718
Fax: (415) 469-4066

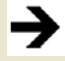

Second Floor Plan

• Accessible ♦ Functionally accessible

Accessibility	Location	Condition
 Access path of travel	Along corridors	•
 Accessible parking stall	Not applicable	
 Passenger loading zone	Not applicable	
 Accessible entrance	Not applicable	
 Ramp	At corridors	
 Boys' toilet, Girls' toilet, Unisex restroom	Unisex staff restroom at end of west corridor	•
 Drinking fountain	None on this floor	
 Elevator	At corridor serves 1st and 2nd floor	•
 TTY (text telephone)	None	

School Access Description

Drinking fountains:

- Drinking fountains located at corridors are not ADA compliant.

Guadalupe Elementary School



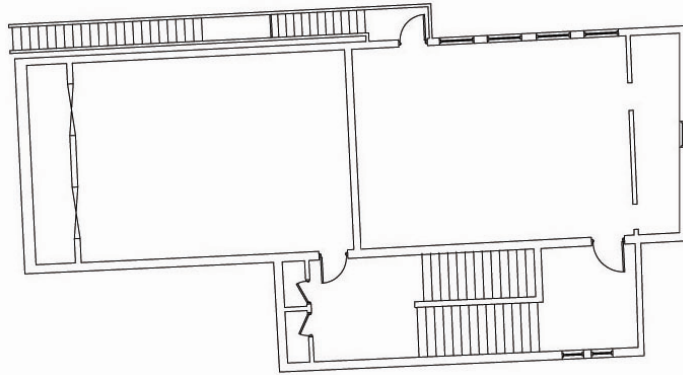





859 Prague Street
San Francisco, CA 94112
Tel: (415) 469-4718
Fax: (415) 469-4066



THIS FLOOR IS NOT ACCESSIBLE

Third Floor Plan

• Accessible ♦ Functionally accessible

Accessibility	Location	Condition
 Access path of travel	Not applicable	
 Accessible parking stall	Not applicable	
 Passenger loading zone	Not applicable	
 Accessible entrance	Not applicable	
 Ramp	Not applicable	
 Boys' toilet, Girls' toilet, Unisex restroom	None on this floor	
 Drinking fountain	None on this floor	
 Elevator	None on this floor	
 TTY (text telephone)	None	

School Access Description

Accessibility:

• Elevator serves 1st and 2nd floor. The 3rd floor is not accessible. Access is via stairs only.