

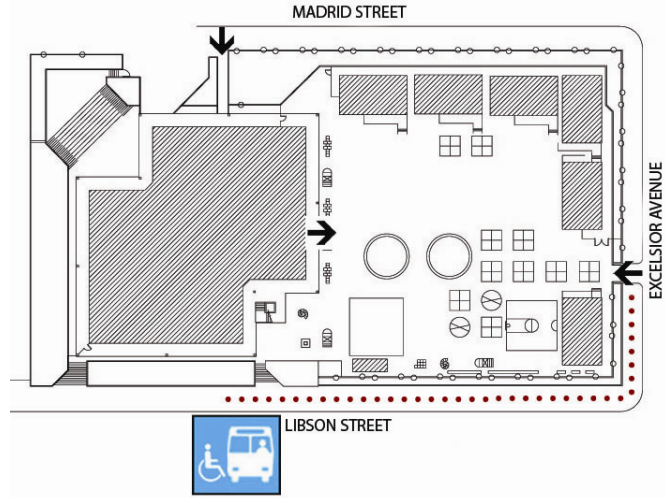









Monroe Elementary School

260 Madrid Street
 San Francisco, CA 94112
 Tel: (415) 469-4736
 Fax: (415) 469-4070



Site Plan

● Accessible ◆ Functionally accessible

Accessibility	Location	Condition
 Access path of travel	From Madrid Street, east side of school From Lisbon Street (south side of school) travel around the street corner to Excelsior Avenue (south side of school)	●
 Accessible parking stall	None	
 Passenger loading zone	On Lisbon Street, west side of school	●
 Accessible entrance	2nd floor main entrance from Madrid Street, east side of school Play yard and portable classrooms from Excelsior Avenue through gate, south side of school	●
 Ramp	At entrance to portable classrooms	●
 Boys' toilet, Girls' toilet, Unisex restroom	See other plans for locations	
 Drinking fountain	On south wall of school	●
 Elevator	See other plans for locations	
 TTY (text telephone)	None	

School Access Description





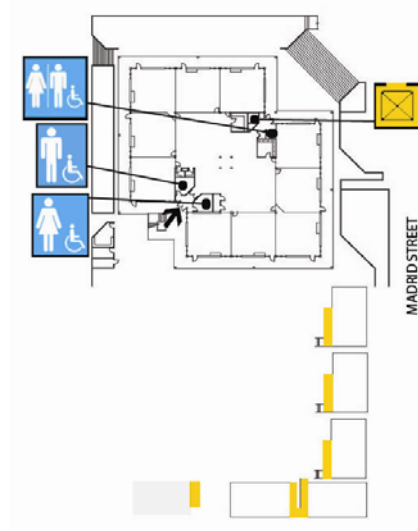



Monroe Elementary School

260 Madrid Street
San Francisco, CA 94112
Tel: (415) 469-4736
Fax: (415) 469-4070



First Floor Plan

● Accessible ◆ Functionally accessible

Accessibility	Location	Condition
 Access path of travel	From Excelsior Avenue through gate across play yard to front entrance	●
 Accessible parking stall	Not applicable	
 Passenger loading zone	Not applicable	
 Accessible entrance	Front entrance from play yard	●
 Ramp	At entrance to portable classrooms	●
 Boys' toilet, Girls' toilet, Unisex restroom	Student restrooms by front entrance Unisex staff restroom by rear entrance	●
 Drinking fountain	None on this floor	
 Elevator	By rear entrance serves two floors	●
 TTY (text telephone)	None	

School Access Description

Drinking fountains:

- Drinking fountain located by elevator is not ADA compliant.





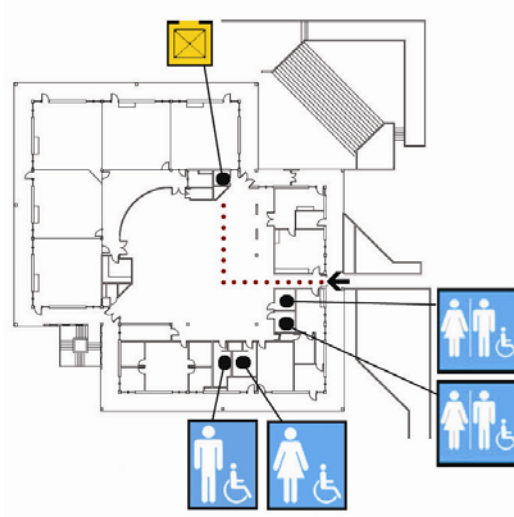



Monroe Elementary School

260 Madrid Street
San Francisco, CA 94112
Tel: (415) 469-4736
Fax: (415) 469-4070

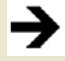

Second Floor Plan

• Accessible ♦ Functionally accessible

Accessibility	Location	Condition
 Access path of travel	Through Multi-Purpose Room to corridor	•
 Accessible parking stall	Not applicable	
 Passenger loading zone	Not applicable	
 Accessible entrance	From Madrid Street, east side of school	•
 Ramp	Not applicable	
 Boys' toilet, Girls' toilet, Unisex restroom	Student and staff restrooms by Multi-Purpose Room	•
 Drinking fountain	None on this floor	
 Elevator	By rear entrance serves two floors	•
 TTY (text telephone)	None	

School Access Description

- Drinking fountains:**
- Drinking fountain located outside of women restroom is not ADA compliant.