

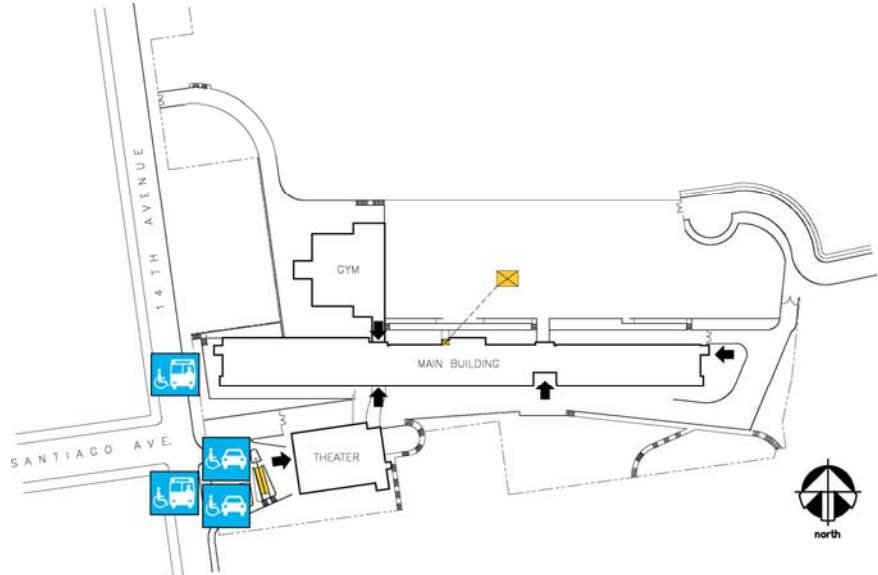









## Herbert Hoover Middle School

2290 14<sup>th</sup> Avenue  
San Francisco, CA 94116  
Tel: (415)759-2783  
Fax: (415)759-2881



### Site Plan

• Accessible ♦ Functionally accessible

| Accessibility   | Location                                     | Condition                                       |
|---|--|---|
|  | Access path of travel                        | from front parking area only ♦                  |
|  | Accessible parking stall                     | lot off 14th Avenue ♦                           |
|  | Passenger loading zone                       | on 14 <sup>th</sup> Avenue, west side of school |
|  | Accessible entrance                          | from front parking area or east side ♦          |
|  | Ramp   | from parking lot to Theater, lower level •      |
|  | Boys' toilet, Girls' toilet, Unisex restroom | not applicable                                  |
|  | Drinking fountain                            | not applicable                                  |
|  | Elevator                                     | not applicable                                  |
|  | TDD (text telephone)                         | not applicable                                  |

### School Access Description

#### Parking:

- There are two accessible parking spaces at the parking lot on the west side of the Theater. These spaces do not serve the main building.
- There are usually parking spaces available at the front of the main building, but none are marked as accessible.

#### Accessibility/Entrance:

- Access to the main school building and the theater is along the upper driveway at the top of the hill.
- Access to the gymnasium is from the main building elevator and across the bridge at the second floor.
- Sidewalks on 14th Avenue are steep, in good condition.

## Herbert Hoover Middle School

2290 14<sup>th</sup> Avenue  
San Francisco, CA 94116  
Tel: (415)759-2783  
Fax: (415)759-2881

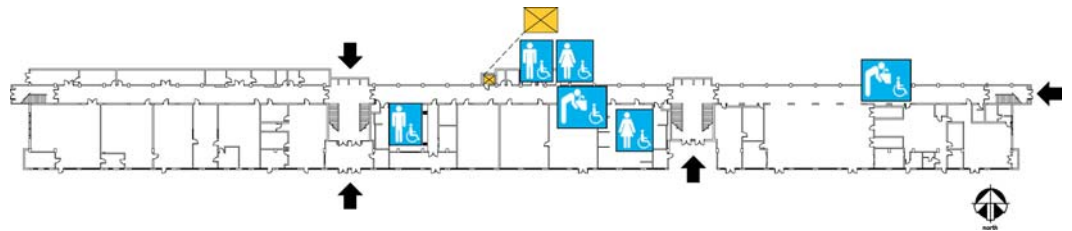

## First Floor Plan

• Accessible ♦ Functionally accessible

| Accessibility |  | Location                                   | Condition |
|---------------|--|--|-----------|
|               | Access path of travel                        | main corridor and elevator                 | •         |
|               | Accessible parking stall                     | not applicable                             |           |
|               | Passenger loading zone                       | not applicable                             |           |
|               | Accessible entrance                          | two south, one east, and one north entries | ♦         |
|               | Ramp   | not applicable                             |           |
|               | Boys' toilet, Girls' toilet, Unisex restroom | main corridor, center                      | ♦         |
|               | Drinking fountain                            | main corridor, center and east side        | •         |
|               | Elevator                                     | main corridor, center                      | •         |
|               | TDD (text telephone)                         | none                                       |           |

### School Access Description

**Restrooms:**

- Girls' and boys toilets on this floor are functionally accessible.

**Drinking fountains:**

- The drinking fountain is ADA compliant.

**Elevator:**

- An elevator is located along the main corridor at the center of the building, accessing all three floor levels.





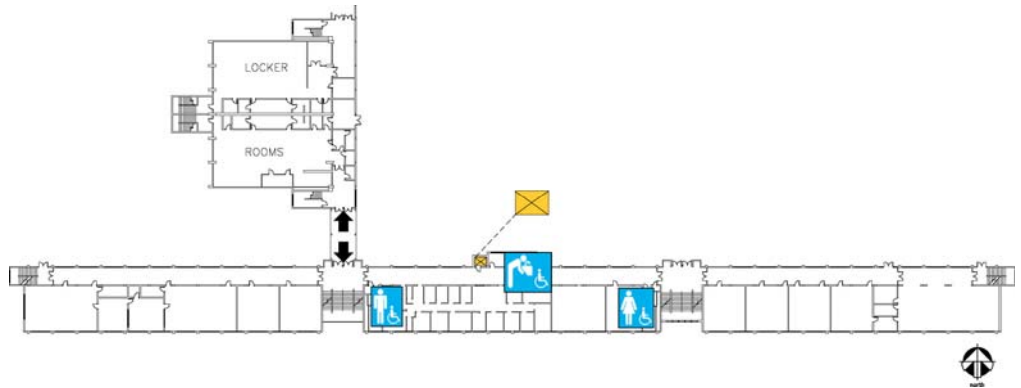



## Herbert Hoover Middle School

2290 14<sup>th</sup> Avenue  
San Francisco, CA 94116  
Tel: (415)759-2783  
Fax: (415)759-2881



## Second Floor Plan

• Accessible ♦ Functionally accessible

| Accessibility  | Location                   | Condition |
|--|----------------------------|-----------|
|  Access path of travel                        | main corridor and elevator | •         |
|  Accessible parking stall                     | not applicable             |           |
|  Passenger loading zone                       | not applicable             |           |
|  Accessible entrance                          | not applicable             |           |
|  Ramp   | not applicable             |           |
|  Boys' toilet, Girls' toilet, Unisex restroom | main corridor, center      | ♦         |
|  Drinking fountain                            | main corridor, center      | •         |
|  Elevator                                     | main corridor, center      | •         |
|  TDD (text telephone)                         | not applicable             |           |

### School Access Description

|                            |   |
|----------------------------|---|
| <b>Restrooms:</b>          | <ul style="list-style-type: none"> <li>Girls' and boys toilets on this floor are functionally accessible.</li> </ul>  |
| <b>Drinking fountains:</b> | <ul style="list-style-type: none"> <li>The drinking fountain is ADA compliant.</li> </ul>   |
| <b>Elevator:</b>           | <ul style="list-style-type: none"> <li>An elevator is located along the main corridor at the center of the building, accessing all three floor levels. The elevator at this level also provides access to the gymnasium via the bridge</li> </ul> |

## Herbert Hoover Middle School

2290 14<sup>th</sup> Avenue  
San Francisco, CA 94116  
Tel: (415)759-2783  
Fax: (415)759-2881

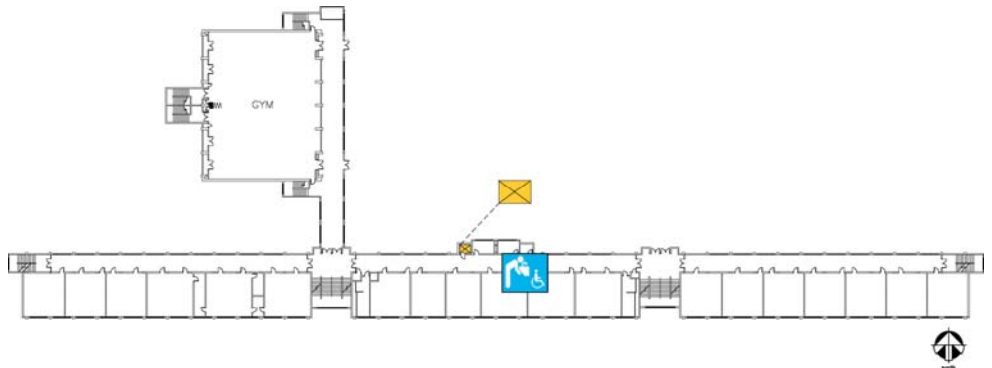

## Third Floor Plan

● Accessible ◆ Functionally accessible

| Accessibility |  | Location                   | Condition |
|---------------|--|----------------------------|-----------|
| ◆             | Access path of travel                        | main corridor and elevator | ●         |
| ◆             | Accessible parking stall                     | not applicable             |           |
| ◆             | Passenger loading zone                       | not applicable             |           |
| ◆             | Accessible entrance                          | not applicable             |           |
| ◆             | Ramp   | not applicable             |           |
| ◆             | Boys' toilet, Girls' toilet, Unisex restroom | not applicable             |           |
| ◆             | Drinking fountain                            | main corridor, center      | ●         |
| ◆             | Elevator                                     | main corridor, center      | ●         |
| ◆             | TDD (text telephone)                         | not applicable             |           |

### School Access Description

- Restrooms:** ● There are no accessible restrooms on this floor.
- Drinking fountains:** ● The drinking fountain is ADA compliant.
- Elevator:** ● An elevator is located along the main corridor at the center of the building, accessing all three floor levels.