

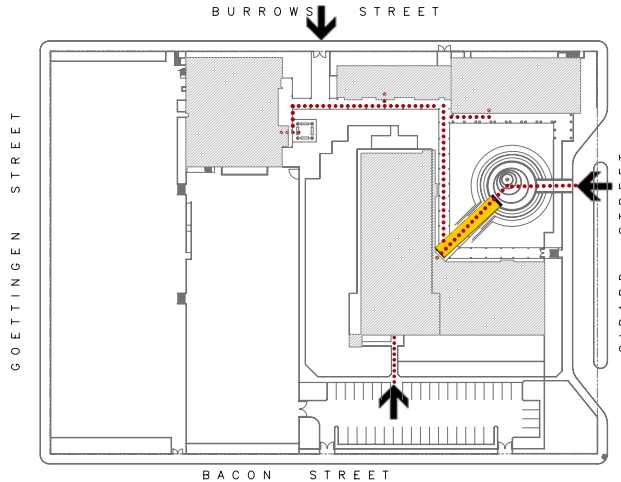









## Dr. Martin Luther King Middle School

350 Girard Street  
 San Francisco, CA 94134  
 Tel: (415) 330-1500  
 Fax: (415) 468-7295



● Accessible ◆ Functionally accessible

## Site Plan

Accessibility	Location	Condition
 Access path of travel	From loading zone to school entrance via existing driveway	◆
 Accessible parking stall	Two stalls in parking lot	◆
 Passenger loading zone	From Girard Street	◆
 Accessible entrance	See First Floor plan	◆
 Ramp	From courtyard up to main entrance of academic building	◆
 Boys' toilet, Girls' toilet, Unisex restroom	Not applicable	
 Drinking fountain	Not applicable	
 Elevator	Not applicable	
 TTY (text telephone)	Not applicable	

### School Access Description

**Parking:** Pole mounted signage only. Both identified stalls share a common loading zone that contains two large concrete bollards. Bollards may limit accessibility of stalls.

**Loading Zone:** Loading zone is not specifically designed for accessibility. Existing driveway allows for wheelchair access up to sidewalk.

## Dr. Martin Luther King Middle School

350 Girard Street  
 San Francisco, CA 94134  
 Tel: (415) 330-1500  
 Fax: (415) 468-7295

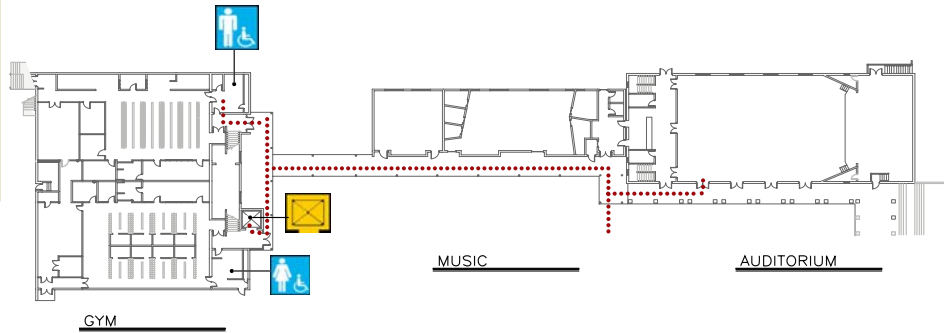

GYM, MUSIC & AUDITORIUM BLDG FIRST FLOOR PLANS



## Gym/ Auditorium Plan

• Accessible ♦ Functionally accessible

Accessibility		Location	Condition
.....	Access path of travel	Connecting Gym and Auditorium with main academic building	♦
	Accessible parking stall	See Site Plan	
	Passenger loading zone	See Site Plan	
	Accessible entrance	Thresholds and opening force exceed code maximums	♦
	Ramp	Not applicable	
	Boys' toilet, Girls' toilet, Unisex restroom	At Locker Room entrances	♦
	Drinking fountain	Exterior drinking fountains are not accessible	
	Elevator	Adjacent to Girls locker room to access gymnasium above.	♦
	TTY (text telephone)	Not applicable	

### School Access Description

**Drinking fountains:** Exterior drinking fountains are enclosed by vandal resistant fencing and are not accessible

**Dr. Martin Luther King Middle School**

350 Girard Street  
San Francisco, CA 94134  
Tel: (415) 330-1500  
Fax: (415) 468-7295











ACADEMIC BLDG – FIRST FLOOR PLAN



● Accessible ◆ Functionally accessible

**First Floor Plan**

Accessibility	Location	Condition
●●●●● Access path of travel	Along corridors	◆
 Accessible parking stall	Not applicable	
 Passenger loading zone	Not applicable	
 Accessible entrance	Two locations: from Girard Street loading and pedestrian entrance and from Bacon Street parking lot entrance	◆
 Ramp	Not applicable	
 Boys' toilet, Girls' toilet, Unisex restroom	No tactile or Braille signage at strike side of entrance doors	◆
 Drinking fountain	Existing drinking fountains are not installed in alcoves	◆
 Elevator	Accessed from main lobby and serves both floors of building	◆
 TTY (text telephone)	Not applicable	

**School Access Description**

**Dr. Martin Luther King Middle School**

# access guide

SAN FRANCISCO UNIFIED SCHOOL DISTRICT

350 Girard Street  
 San Francisco, CA 94134  
 Tel: (415) 330-1500  
 Fax: (415) 468-7295

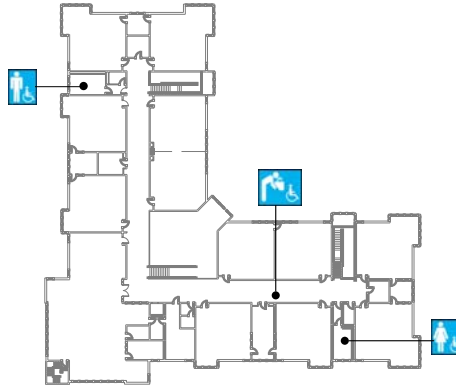

ACADEMIC BLDG – SECOND FLOOR PLAN



● Accessible ♦ Functionally accessible

## Second Floor Plan

Accessibility		Location	Condition
.....	Access path of travel	Along corridors	♦
	Accessible parking stall	Not applicable	
	Passenger loading zone	Not applicable	
	Accessible entrance	Not applicable	
	Ramp	Not applicable	
	Boys' toilet, Girls' toilet, Unisex restroom	No tactile or Braille signage at strike side of entrance doors	♦
	Drinking fountain	In wall type with knee space framed below	♦
	Elevator	Accessed from main lobby and serves both floors of building	♦
	TTY (text telephone)	Not applicable	

### School Access Description

--